

TECHNICAL DETAILS HINGES

X91 AND X95



X91



X91 HINGES WITH Ø35 CUP

4



X91N HINGES WITH Ø35 CUP

4

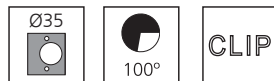

X91 HINGES ANGLED ARM WITH Ø35 CUP

5



X91 PLATES

6

X95



X95 HINGES WITH Ø35 CUP

8



X95 PLATES

8

HINGES X91

INFORMATION

X91		SLOW	CLIP						
<p>X91</p>	<p>100°</p>	<p>Ø35 D = 3 ~ 7 mm</p>	<p>14 ~ 24 mm</p>	<p>RECTA</p>		1040007	Ø4x16 5032305 Ø4x15 5000907 Ø3,5x16 5000807		
				<p>RECTA</p>		1040107	Ø10x10		
				<p>CODO</p>		1040207	Ø4x16 5032305 Ø4x15 5000907 Ø3,5x16 5000807		
				<p>CODO</p>		1040307	Ø10x10		
				<p>SUPERCODO</p>		1040407	Ø4x16 5032305 Ø4x15 5000907 Ø3,5x16 5000807		
				<p>SUPERCODO</p>		1040507	Ø10x10		
<p>X91</p>	<p>100°</p>	<p>Ø35 D = 3 ~ 7 mm</p>	<p>14 ~ 24 mm</p>	<p>BRAZO 45°</p>		1040607	Ø4x16 5032305 Ø4x15 5000907 Ø3,5x16 5000807		
				<p>BRAZO 90°</p>		1040707	Ø4x16 5032305 Ø4x15 5000907 Ø3,5x16 5000807		

X91N		CLIP							
<p>X91N</p>	<p>100°</p>	<p>Ø35 D = 3 ~ 7 mm</p>	<p>14 ~ 24 mm</p>	<p>RECTA</p>		1040807	Ø4x16 5032305 Ø4x15 5000907 Ø3,5x16 5000807		
				<p>CODO</p>		1040907	Ø4x16 5032305 Ø4x15 5000907 Ø3,5x16 5000807		
				<p>SUPERCODO</p>		1041007	Ø4x16 5032305 Ø4x15 5000907 Ø3,5x16 5000807		

Height	Screw-on	Euro
PLATES		
H = 0	1041107	1041307
H = 2	1041207	1041407
PLATE WITH ECCENTRIC REGULATION		
H = 0	1041507	1041707
H = 2	1041607	1041807

X91 AND X91N HINGES

- Integrated soft closing mechanism.
- Hinge to plate quick fixing system.
- Lighting angle: 100°
- Diametre cup: Ø35
- Adjustable in 3 dimensions.
- Door thickness: 14 - 24 mm.
- Distance to cup bore edge: 3 - 7 mm
- Spring in opening and closing.
- For the assembly, we recommend to use screws flat head Ø4 x 16 Cod. 5032305 or raised head Ø4 x 15 Cod. 5000907

X91 HINGES WITH Ø35 CUP



Full overlay hinge

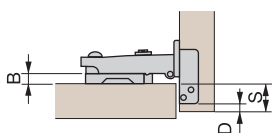

$$B = 15 + D - S$$

Half overlay hinge

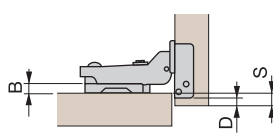

$$B = 5 + D - S$$

Insert hinge

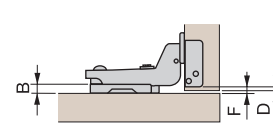

$$B = D + F - 4$$

CUP PLATE SYSTEM

Screw-on:

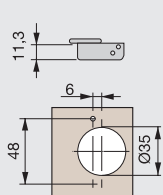

Knock-in:

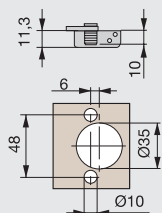

Hinge	Description	Cod.		
Full overlay hinge	Screw-on	10400	07	200
Full overlay hinge	Knock-in Ø10	10401	07	200
Half overlay hinge	Screw-on	10402	07	200
Half overlay hinge	Knock-in Ø10	10403	07	200
Inset hinge	Screw-on	10404	07	200
Inset hinge	Knock-in Ø10	10405	07	200

Steel

X91N HINGES WITH Ø35 CUP AND WITHOUT PISTÓN



Full overlay hinge

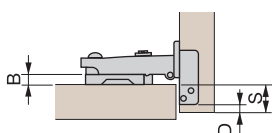

$$B = 15 + D - S$$

Half overlay hinge

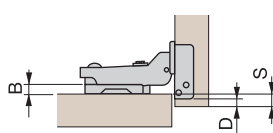

$$B = 5 + D - S$$

Insert hinge

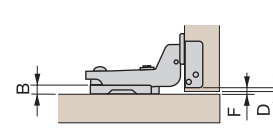

$$B = D + F - 4$$

CUP PLATE SYSTEM

Screw-on:

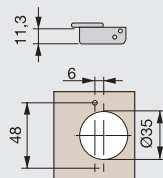

Hinge	Description	Cod.		
Full overlay hinge	Screw-on	10408	07	200
Half overlay hinge	Screw-on	10409	07	200
Inset hinge	Screw-on	10410	07	200

Steel

X91 HINGES ANGLED ARM

- Integrated soft closing mechanism.
- Hinge to plate quick fixing system.
- Lighting angle: 100°
- Diametre cup: Ø35
- Adjustable in 3 dimensions.
- Door thickness: 14 - 24 mm.
- Distance to cup bore edge: 3 - 7 mm

- Spring in opening and closing.
- For the assembly, we recommend to use screws flat head Ø4 x 16 Cod. 5032305 or raised head Ø4 x 15 Cod. 5000907

X91 HINGES ANGLED ARM WITH Ø35 CUP



45° Hinge

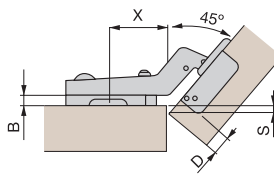

Description	Cod.		
Screw-on	10406	07	200
Steel			

B	D			
	4	5	6	7
0	37 4,5	36 5,4	35 6,3	34 7,2
2	37 2,5	36 3,4	35 4,3	34 5,2
X		S		

CUP PLATE SYSTEM

Screw-on:

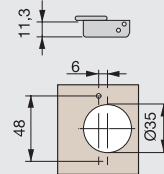

90° Hinge

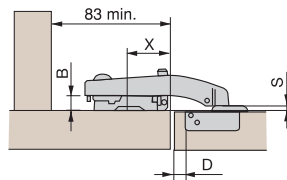

Description	Cod.		
Screw-on	10407	07	200
Steel			

B	D	
	4	5
0	20 2,8	19 2,8
2	20 0,8	19 0,8
X		S

CUP PLATE SYSTEM

Screw-on:

