

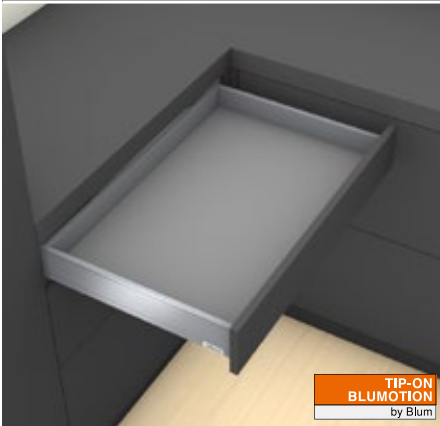

TIP-ON BLUMOTION



- The TIP-ON mechanical opening support system combined with soft-close BLUMOTION
- Gap 2.5 mm
- Four-dimensional front adjustment
- Extensive trigger range
- Synchronised feather-light glide
- Synchronisation for internal cabinet widths LW of 245 mm and wider

TIP-ON BLUMOTION by Blum

Order information

1	Cabinet profiles left/right	
	BLUMOTION S	
Nominal length NL (mm)	Dynamic carrying capacity (kg)	
	40	70
270	750.2701S	
300	750.3001S	
350	750.3501S	
400	750.4001S	
450	750.4501S	753.4501S
500	750.5001S	753.5001S
550	750.5501S	753.5501S
600	750.6001S	753.6001S
650		753.6501S

6.1 TIP-ON BLUMOTION set

Nominal length NL (mm)	Unit	Cabinet profile (kg)	Weight (kg)	1	Part no.
270-300	S0	40	≤ 10		T60L7040
270-300	S1	40	> 10-20		T60L7140
350-600	L1	40	≤ 20	2	T60L7340
350-600	L3	40	15-40	2	T60L7540
450-650	L5	70	35-70	3	T60L7570

Composed of:

- 6a 1 x TIP-ON BLUMOTION unit left/right
 - 6b 1 x TIP-ON BLUMOTION latch left/right
 - 6e 2 x TIP-ON BLUMOTION synchronisation adapter
Internal cabinet width LW ≥ 294 mm
- 1 Recommended weight ranges (total weight of the pull-out) for an optimum opening and closing function
- 2 Can only be combined with a 40 kg cabinet profile
- 3 Recommendation: only use in combination with 70 kg cabinet profile

6.2 TIP-ON BLUMOTION set sink pull-out

Nominal length NL (mm)	Unit	Cabinet profile (kg)	Weight (kg)	1	Part no.
350-600	L1	40	≤ 20	2	T60L9340
350-600	L3	40	15-40		T60L9540

Composed of:

- 6c 1 x TIP-ON BLUMOTION unit left/right
 - 6d 1 x TIP-ON BLUMOTION latch left/right
 - 6e 2 x TIP-ON BLUMOTION synchronisation adapter
Internal cabinet width LW ≥ 314 mm
- 1 Recommended weight ranges (total weight of the pull-out) for an optimum opening and closing function
- 2 Can only be combined with a 40 kg cabinet profile

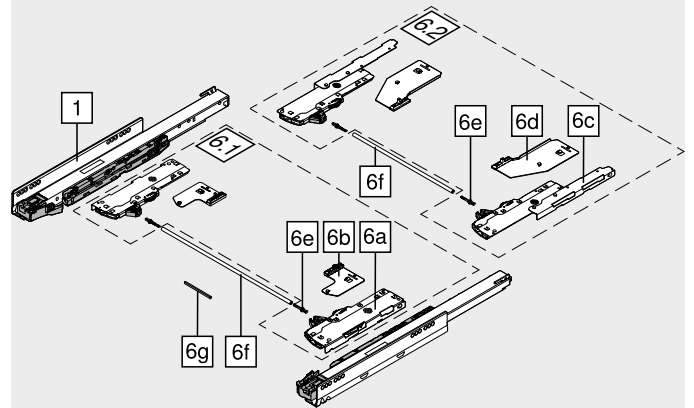

Internal cabinet width LW ≥ 294 mm

6f	TIP-ON BLUMOTION synchronisation linkage		
Version	Colour	Part no.	
Round	Grey	T60.1125W	

In combination with 6e 2 x T60.000D
Suitable up to internal cabinet width LW 1370 mm

Note

To optimise the function and trigger range, we generally recommend using synchronisation

Cutting

- 6.1 Internal cabinet width LW – 247 mm
- 6.2 Internal cabinet width LW – 267 mm

Internal cabinet width LW 245-293 mm

6g	TIP-ON BLUMOTION synchronisation		
Version	Colour	Part no.	
Square	RAL 7035 light grey	T60.300D	

Cutting

- 6.1 Internal cabinet width LW – 221 mm

Accessories

6e	TIP-ON BLUMOTION synchronisation adapter		
Version	Colour	Part no.	
Symmetrical	RAL 7035 light grey	T60.000D	

Internal cabinet width LW ≥ 294 mm

Front gap template for TIP-ON BLUMOTION			
Front gap FS (mm)	Colour	Part no.	
2.5	Orange	65.5631	