

# opk E-Space APP Application & Parameter Adjustment

**Power-on System Self-learning**

plug & play, bei Strom an, lernt sich das System selbständig ein

The system detects automatically the door opening width. The detection is completed when the door stops.

**Push and Close**

**Product Name: Smart Sliding Door System**

Rated voltage	200 ~ 240V / 50Hz	Rated power	70W
Standby power	5W	ISM frequency	433.92MHz
Bluetooth frequency	2402 ~ 2480MHz	Door opening speed	Min 0.065M/S Max 0.26M/S
Control mode	Microcomputer controller	Collision function	Rebound when blocked or collided conditions
Manual opening and closing force during power off	E-Space ≤ 10N	Temperature range	-20 ~ 40 °C

**Find App**

Download and Install APP

android
 
 Google Play
 
 OPK Smart Home

iOS
 
 App Store
 
 OPK Smart Home

01. Open the app

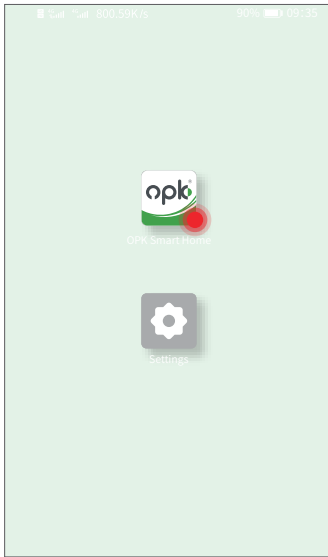

02. Click optional position

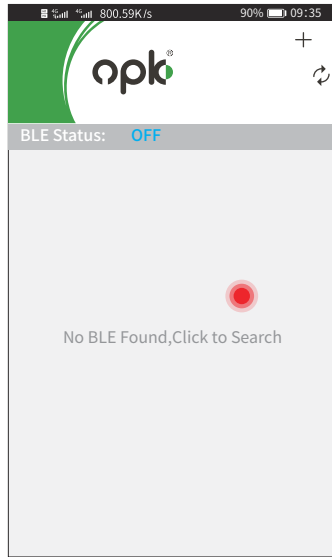

03. Turn on the bluetooth

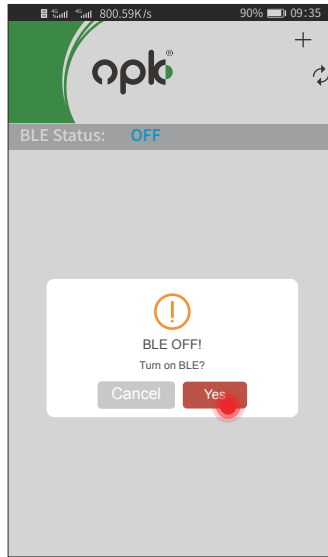

04. Click OK. Begin to search the equipment

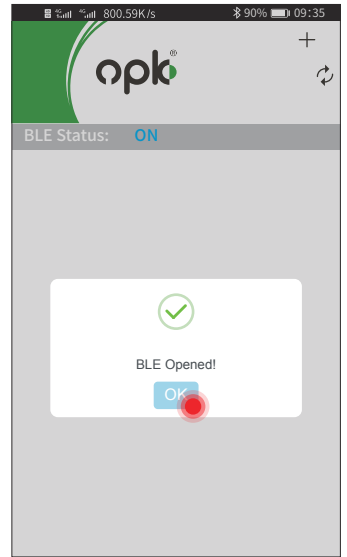

05. Find device

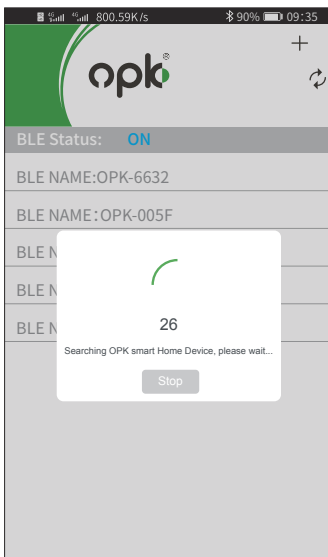

06. Click on the device, select the corresponding device name to connect

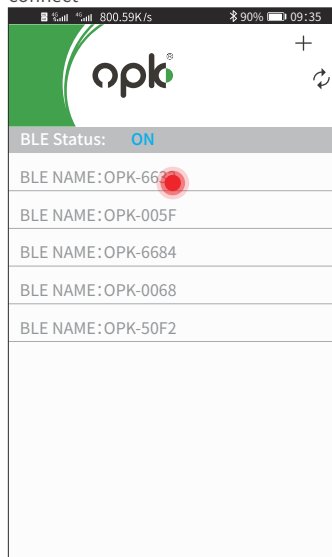

07. Device connecting

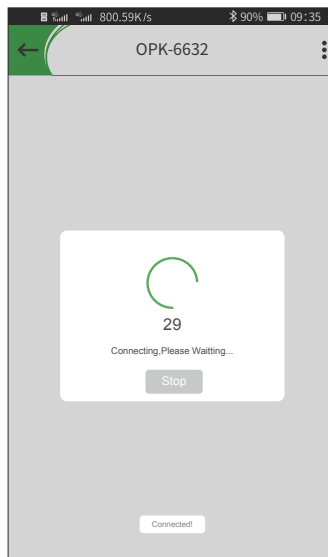

08. Test whether the direction of the door panel is correct

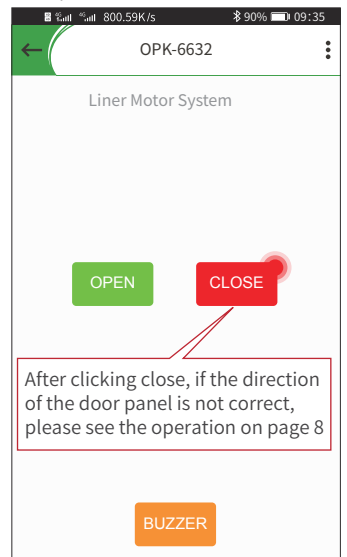

09. Click the signal at the top right

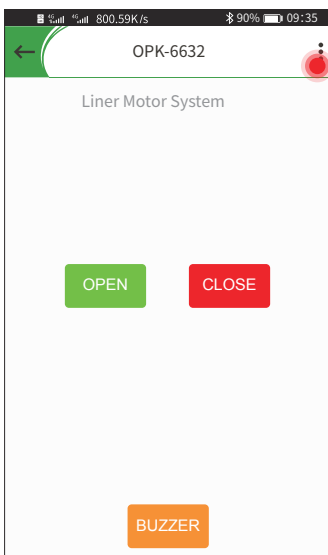

10. Open the operating parameters adjustment

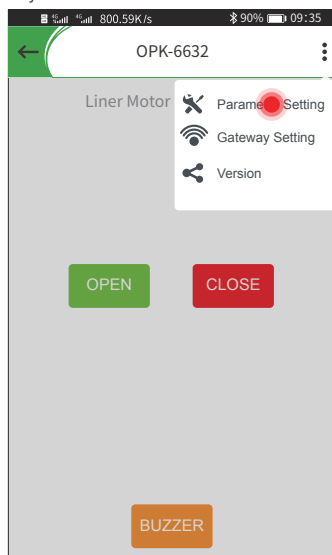

11. Click the "SELF-STUDY" button, the system starts to detect the door weight

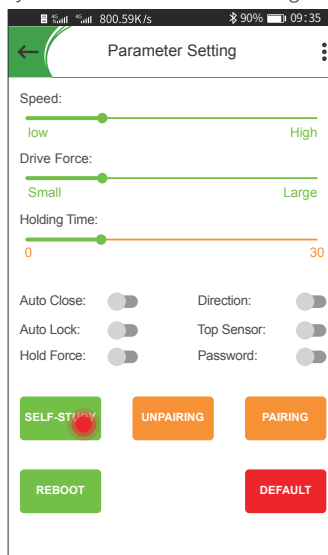

# Introduction to Operating Parameters

Adjust the sliding speed of door panel

Adjust the driving force according to the actual door weight to change the operating effect

Adjust the staying time after the door panel is opened (when button "Auto Close" is on)

OFF: Single door open or close manually  
ON: Door close automatically

ON: The door can be automatically locked after closing, just for the track system with opk lock (all the sensors connected to the "SENS" terminal will be out of function)

OFF: Normal closing force  
ON: Increased closing force

The system self learning

Restart the system

Delete all paired devices in the system

Change the door panel sliding direction to the wished direction

When top sensor is installed:  
OFF :Top sensor is off  
ON:Top sensor is on, only when the "Auto Lock" is off

When on, set a password of more than 8 digits (When a password is set, all mobile phones must enter the password for each operation to issue instructions)

Press button "PAIRING", a continue "di.di.di..." sound from track system, press any button of the remote to be connected devices.

OFF ON

Speed: low High

Drive Force: Small Large

Holding Time: 0 30

Auto Close: OFF ON

Auto Lock: OFF ON

Hold Force: OFF ON

Direction: OFF ON

Top Sensor: OFF ON

Password: OFF ON

SELF-STUDY UNPAIRING PAIRING

REBOOT DEFAULT

# Cable Connecting Instruction of the Control Port

Function	Wiring connection
24V	24V voltage line output
LOCK	Lock wire, connect to electric lock wire
GND	Ground wire
SENS	Sensor signal input, low level
OPEN	Door open signal input, low level
L-IN	Safety light input, low level
CAN2L	CAN LOW
CAN2H	CAN HIGH
CAN1L	Reserving for other usage
CAN1H	Reserving for other usage

Smart sensor

EXIT switch

Microwave sensor

24V GND

NO COM

LOCK

24V GND COM NO

24V GND COM NO

Split safety light

24V NPN GND

Integrated safety light

Reserving for other usage

CANL to another track

CANH on another track

Synchro system

## Single system / Schiene

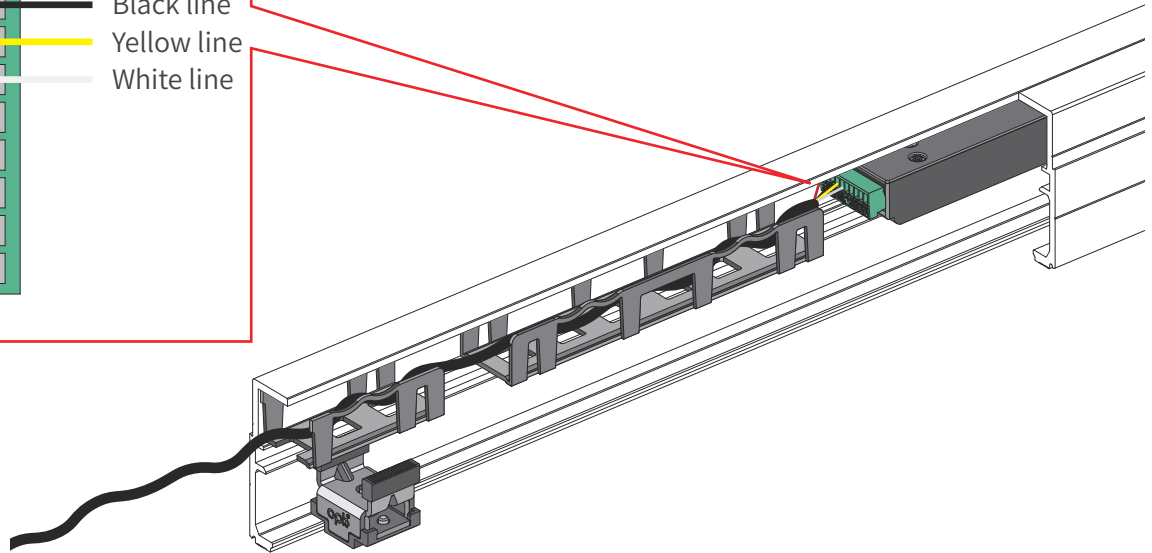
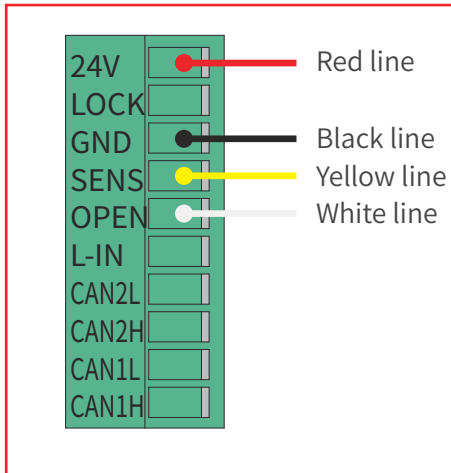

Please take off the plug from the power grid –  
bei Arbeiten an elektrischen Bauteilen immer den Netzstecker ziehen

## Double systems / Schienen (synchro system)

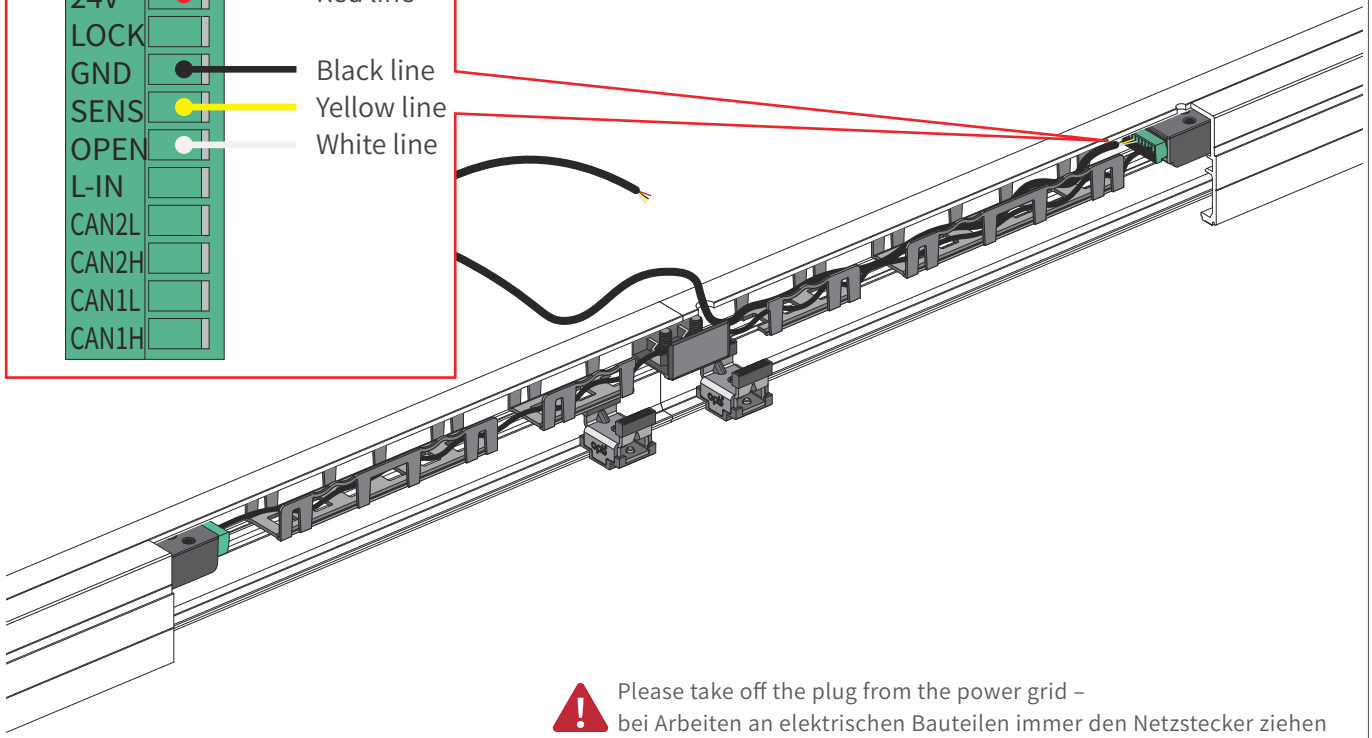
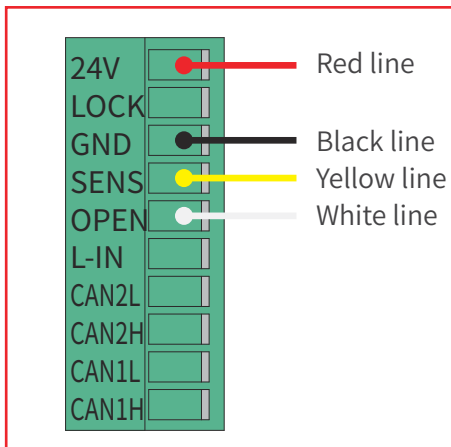

Please take off the plug from the power grid –  
bei Arbeiten an elektrischen Bauteilen immer den Netzstecker ziehen

# opk CleanSwitch Kabelverbindung/ Cable connection

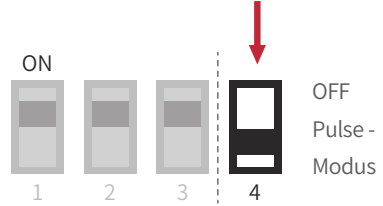
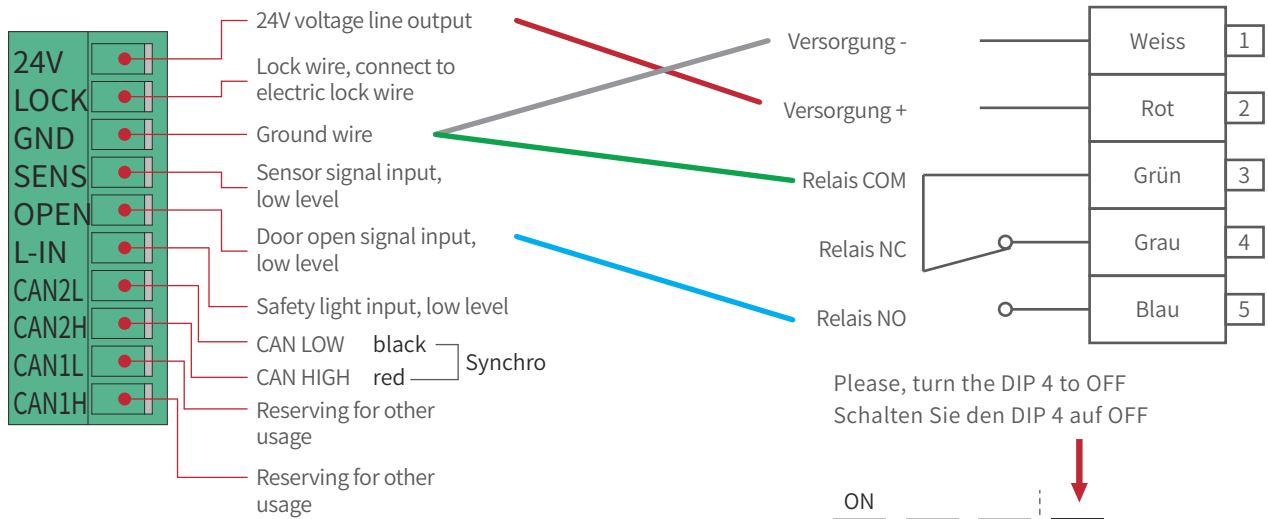

An der Grundeinstellung des CleanSwitch muss nur der Pulse Modus geändert werden.  
At the basic setting of CleanSwitch, only the Pulse Modus has to be changed.

Please take off the plug from the power grid -  
bei Arbeiten an elektrischen Bauteilen immer den Netzstecker ziehen

# opk PrimeMotion B

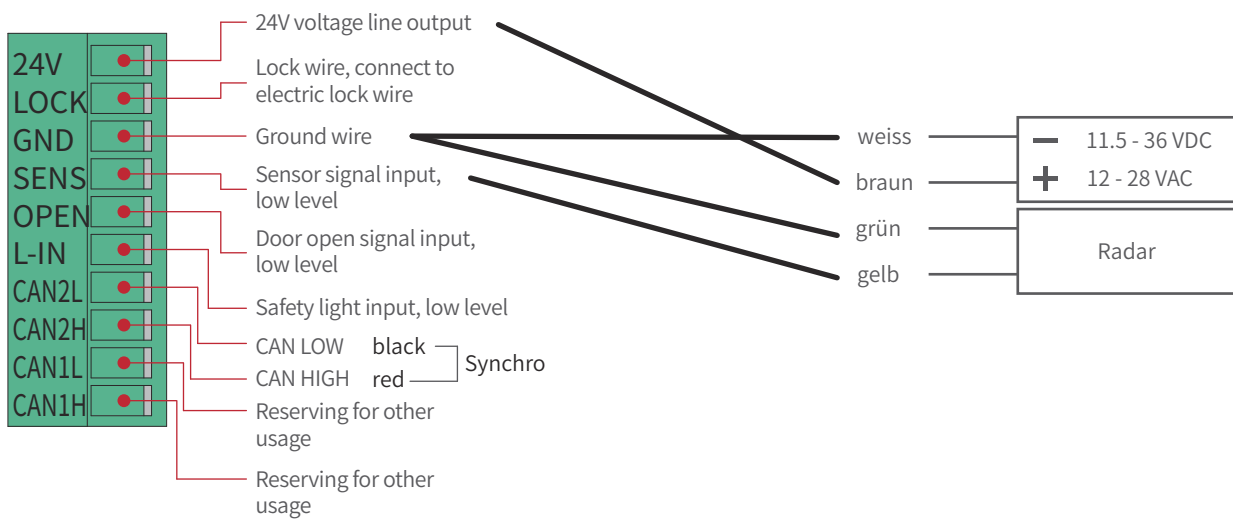

Please take off the plug from the power grid -  
bei Arbeiten an elektrischen Bauteilen immer den Netzstecker ziehen

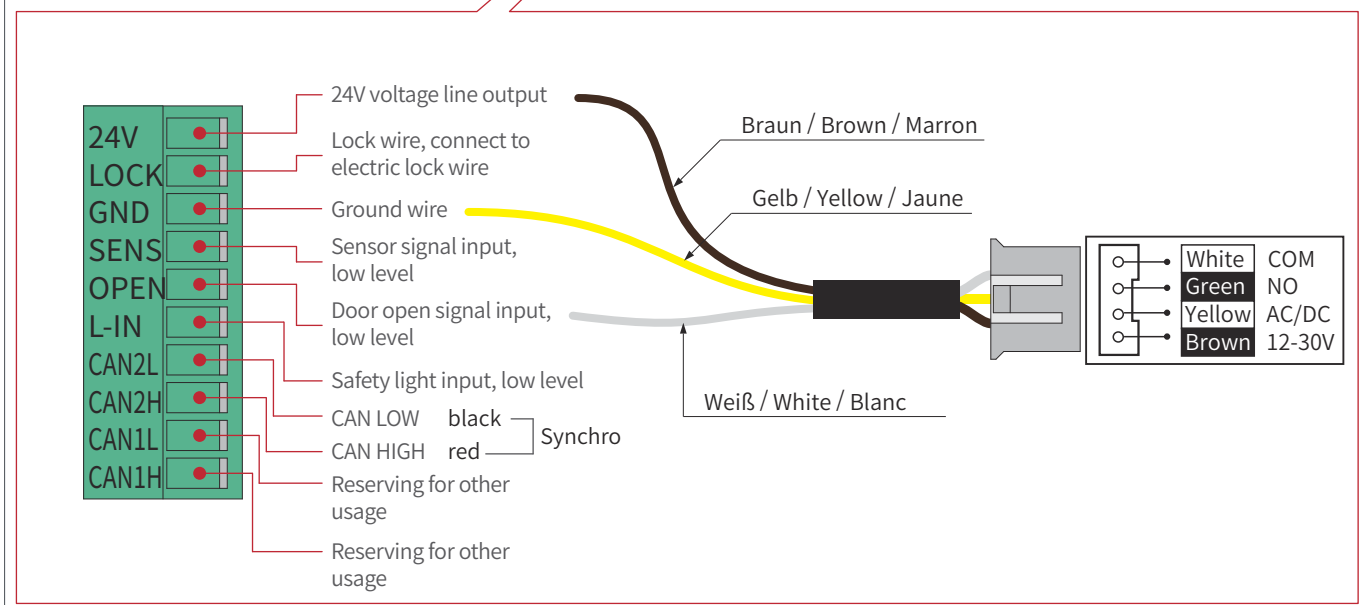
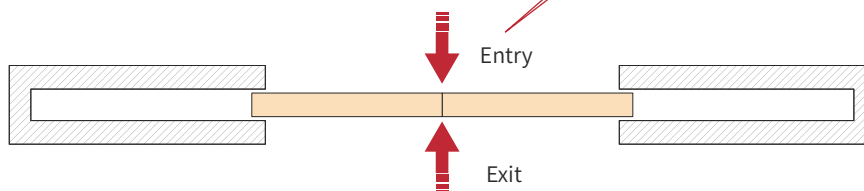
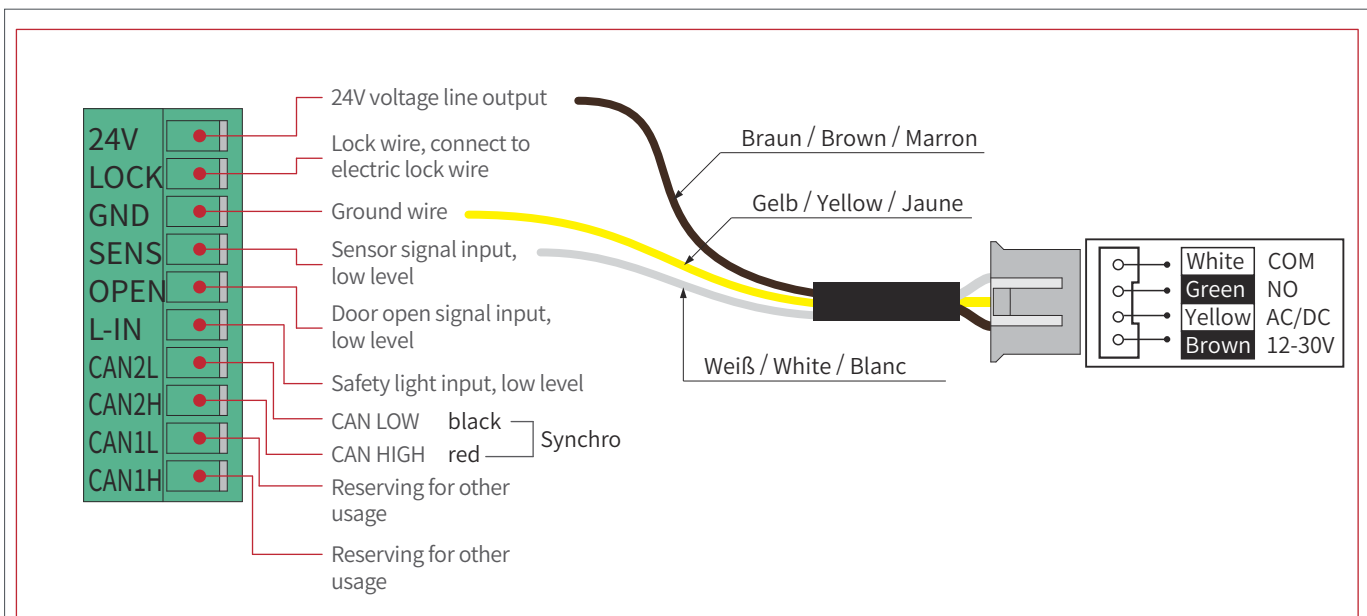

Press "PAIRING" button

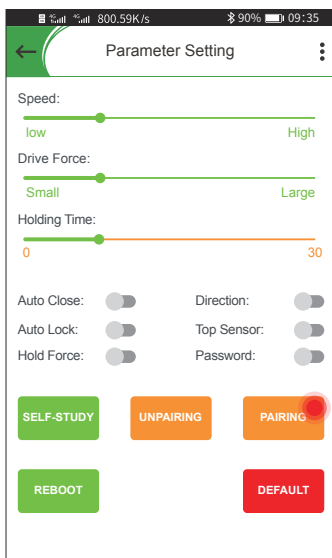

During continuous "di di di..." sounding from the track system press the remote control; the sound stops, remote control pairing is done.

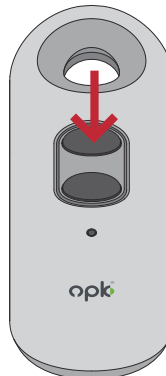

## Change Battery

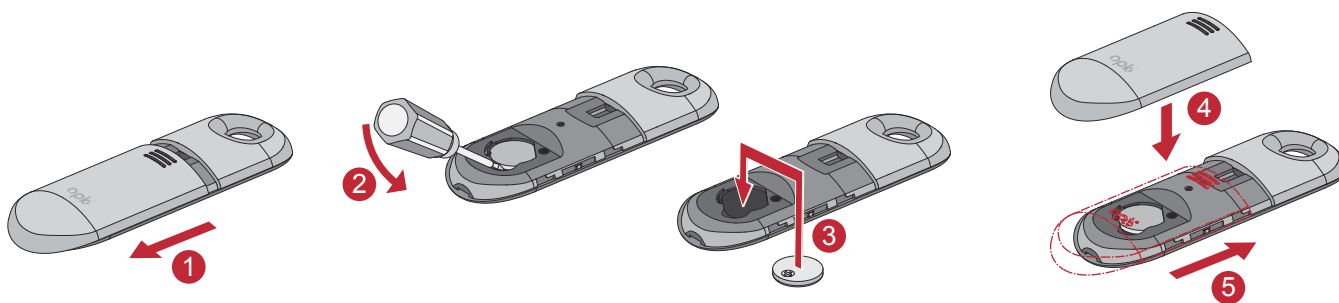

## Technical Parameters

Power supply (Wireless receiver)	DC24V	Emission current (Transmitter)	<15mA
Static current	100mA	Receiver sensitivity	-96dBm
Action current	150mA	Life of battery (Transmitter)	The average press 100 time per day, can withstand 800 days
Main contact capacity (Wireless receiver)	N/A	Emission distance	Over 20 meters in no obstacles area
Contact suction holding time (Wireless receiver)	N/A	Product size (Transmitter)	128mm(L)X49MM(W)X19MM(H)
Power supply (Transmitter)	3V battery	Product size (Receiver)	155mm(L)X30MM(W)X20MM(H)
Standby current (Transmitter)	<0.01uA		

## Einstellung und Korrektur des Synchrosystems How to solve the abnormal moving direction of the door panel of the synchro system

Wenn nur eine Tür bei 'close' in die Schliessposition fährt, die Schaltfläche 'direction' drücken, ein Signal ertönt. An der offenen Tür ziehen, der Signalton bestätigt sich und beide Türen schliessen gemeinsam.

**Case 1: After clicking the "CLOSE" button, there is a door which is not in the middle**

Solution:

Click the "Direction" button, the track emits a continuous sound of "Didi Di...", pull the wrong door panel, the door panel starts to walk, and the sound stops, the door panel direction change completed

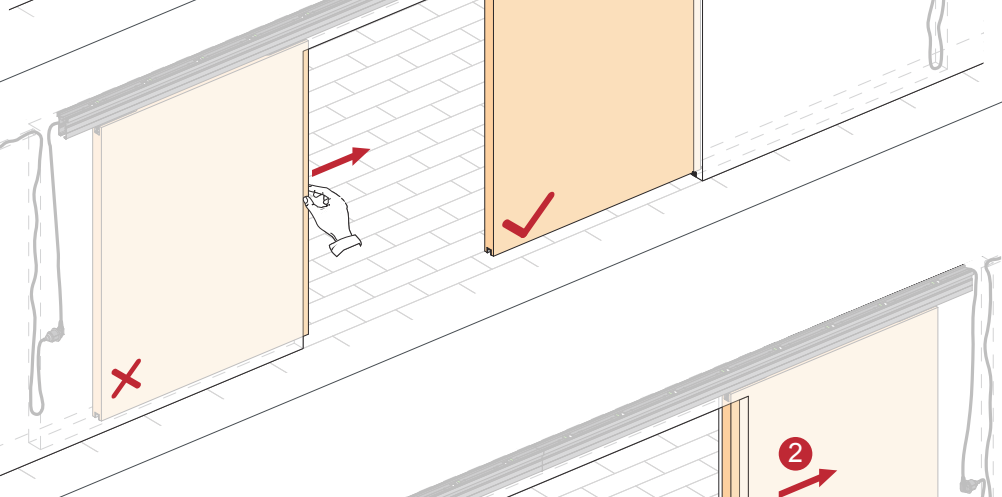
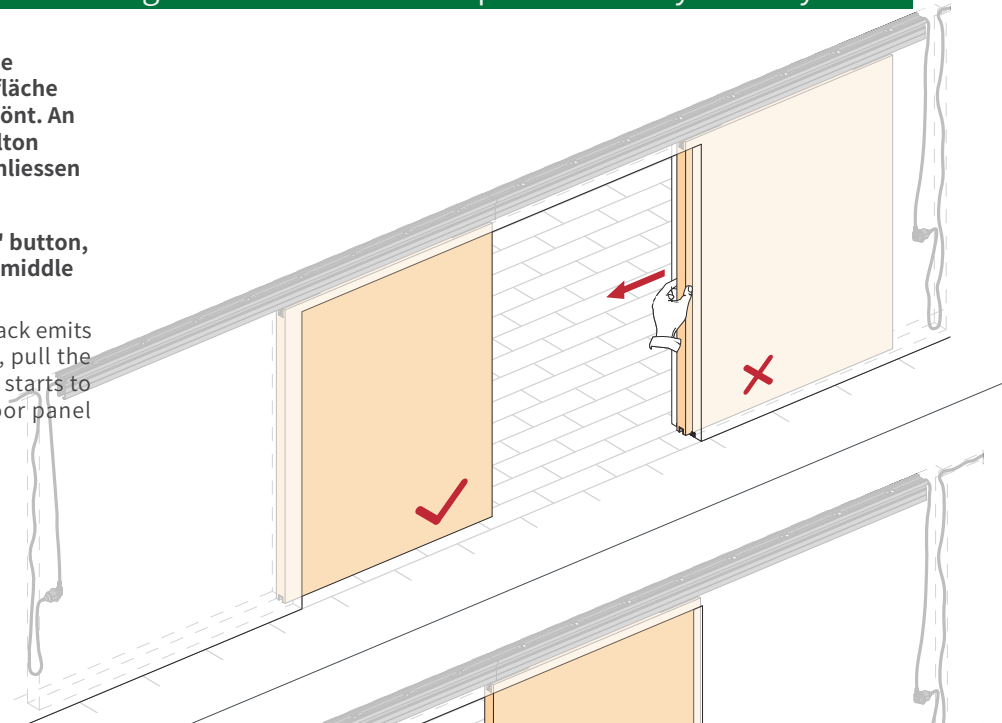
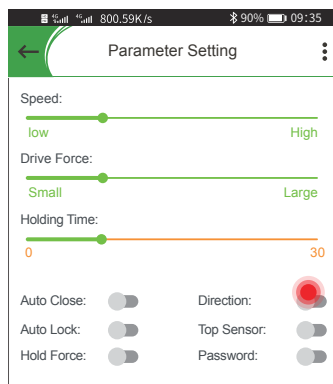
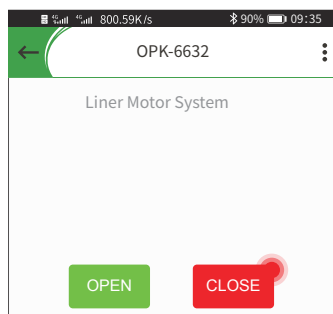

**Wenn die Richtung schliessen / öffnen vertauscht ist:**

Schaltfläche 'Richtung' / 'Direction' drücken, ziehen Sie an der linken Tür und diese bewegt sich. Wenn der Signalton erlischt, ist die Richtung geändert. Ebenso bei der rechten Tür.

**When the "OPEN" or "CLOSE" button on the APP control door is opposite to the actual door movement direction.**

**How to solve:**

Click the "Direction" button, track system will have a continuous sounds like "Dididi". Then pull the left door, and the door starts walking, when the sound stops and the direction change of the door is completed. The right door repeats this operation.

